

Media: air – water – gas – light oil - vacuum  
 Pressure range: 0 to 15 bar max  
 Media temperature: 185°C max  
 Ambient temperature: -10°C to +50°C max  
 Media viscosity: 50 centistokes max  
 Mounting: any position  
 Opening / Closing time: 20 mSec Max

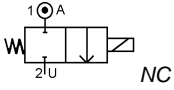

# 2/2 Stainless

1/8 - 1/2

## NORMALLY CLOSED

## 2 WAY DIRECT ACTING

0 – 15 Bar

### TYPE ADS612



#### PRESSURE

Ø Port BSP	Ø Orifice (mm)	Coil	Flow Kv Ltr/min	Pressure Rating (bar) ΔP			Seals	Part Number
				Min	Max AC	Max DC		
1/8	3.0	WPG1	4	0	10	7	NBR +80°C SILICONE +120°C EPDM +120°C FKM +120°C *PTFE +185°C *VST +185°C	ADS6A + seal + voltage
	4.0		5.5	0	7	5		ADS6B + seal + voltage
	5.0		7.2	0	5	3.5		ADS6C + seal + voltage
1/4	3.0		4	0	10	7		ADS8A + seal + voltage
	4.0		5.5	0	7	5		ADS8B + seal + voltage
	5.0		7.2	0	5	3.5		ADS8C + seal + voltage
3/8	4.0	WPG2	5.5	0	10	7		ADS10A + seal + voltage
	6.0		10.5	0	5	3.5		ADS10B + seal + voltage
	8.0		16.2	0	2	1.4		ADS10C + seal + voltage
	1/2	4.0	WPA3C	5.5	0	15		10
		6.0		10.5	0	7	5	ADS10B-C3 + seal + voltage
		8.0		16.2	0	3	2	ADS10C-C3 + seal + voltage
1/2	6.0	WPG2	10.5	0	5	3.5	ADS12A + seal + voltage	
	8.0		16.2	0	2	1.4	ADS12B + seal + voltage	
	1/2	WPA3C	6.0	0	7	5	ADS12A-C3 + seal + voltage	
			8.0	0	3	2	ADS12B-C3 + seal + voltage	

#### OPTIONS

IP67 (EN60529:1991+A1:2000) UL + CSA Approved Coil + IP65 Connector PG11 with LED – DIN 43650 A  
 ATEX EExmII T4 II 2G & 2D IP65 T130°C coil. (Pressure rating WPG1 same, WPG2 70% of DC rating, WPA3C not available)  
 Silver shading ring (ADSxxxS)  
 \* PTFE, VST, CR, ECO, HNBR or Hypalon Seals  
 Manual Over Ride (ADS8 – 10)  
 NPT Thread

#### ELECTRICAL DATA

Voltage (-10% + 15%) Continuous duty 100%	Coil	Power Consumption		Insulation class	Enclosure	Electrical connections
		Inrush	Holding			
~ 24 - 110 - 230 (50 or 60 Hz)	WPG1	11.2VA	8.2VA	H 180°C	IP 65 with connector	3 spades DIN 43650A DIN 40050 VDE 0110
= 12 - 24 (DC)		12 Watts				
~ 24 - 110 - 230 (50 or 60 Hz)	WPG2	18.7VA	15.3VA			
= 12 - 24 (DC)		18 Watts				
~ 24 - 110 - 230 (50 or 60 Hz)	WPA3C	88VA	57VA	N 200°C	IP54	30cm flying lead wire
= 12 - 24 (DC)		33.6 Watts				

#### CONSTRUCTION

Body: Forged 316 stainless steel (CF8M)  
 Tube 304 stainless steel, armature 430F stainless steel  
 Shading ring: copper (Optional Silver)  
 Seals and gaskets: FKM (Optional EPDM, NBR, SILICONE, PTFE, VST, CR, ECO, HNBR and Hypalon)  
 Moulded coil: Resin

#### REPAIR KIT

Coil	Coil (WPG1 or WPG2 or WPA3C) + voltage
Armature + Seal assembly	SP210 + Valve Part Number

#### OVERALL DIMENSIONS

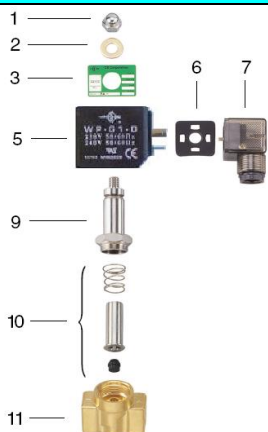

Item	Part No	Description
1	SP201-*	Nut
2	SP202-*	Washer
3	SP203-*	Nameplate
5	WPG*	Coil
6	SP206-*	Gasket
7	SP207-*	Connector
9	SP209-*	Core Tube
10	SP210-*	Armature Assembly
17	SP211-*	Valve Body

\* = Valve Part Number

Model	A	B	C	F	G	H	Kg
ADS8	41	19	89	63	15	10.5	0.47
ADS10	50	25	90	65	15	11.7	0.73
ADS12	55	27	91	65	17	13	0.78

