

Media: according to tube specifications
 Pressure range: 0 to 1 Bar max
 Media temperature: -10°C +100°C max
 Ambient temperature: -20°C to +40°C
 Media viscosity: 50 centistokes max
 Mounting: any position
 Tubing: 55 - 60 Shore Hardness
 Opening or Closing time: 500mSec Max

2/2 + 4/2 Pinch

6x4 - 8x5 - 9.5x6.5
NORMALLY CLOSED
DIRECT ACTING
 0 – 1 Bar
TYPE PV



PRESSURE

Ø Tube Size	Function	Ø Orifice	Pressure Rating (bar) ΔP		Seals	Part Number
			Min	Max		
6x4	2/2 NC	4	0	1	Silicone Tube	PV6X4-2 + voltage
8x5		5	0	1	Silicone Tube	PV8X5-2 + voltage
9.5x6.5		6.5	0	1	Silicone Tube	PV9.5X6.5-2 + voltage
6x4	4/2 NC	4	0	1	Silicone Tube	PV6X4-3 + voltage

OPTIONS

IP65 Coil + PG9 IP65 Connector DIN 43650A
 High power 14 Watt coil (70% Duty only) for 4/2 way valve
 Tube sizes up to 15 x 21 and normally open versions
 Aluminium body
 Stainless steel body

ELECTRICAL DATA

Voltage (-5% + 10%) Continuous duty 70%		Coil	Power Consumption		Insulation class	Enclosure	Electrical connections
~	=		Inrush	Holding			
12 - 24 - 48 - 110 - 230 (Rectified)	6 - 12 - 24 - 48 - 110 (DC)	11630	26VA	14VA	F 155°C	IP 65 with connector	3 spades DIN 43650 DIN 40050 VDE 0110
=			10 Watts				
=	6 - 12 - 24 - 48 (DC)	31400	14 - 20 Watts				

CONSTRUCTION

Body: Mazak
 Tube and internal parts: Stainless steel
 Seals and gaskets: Silicone
 Moulded coil: Resin

REPAIR KIT

Armature	SP + Valve Part Number - ARMATURE
Coil	11630 or 31400 + voltage

OVERALL DIMENSIONS

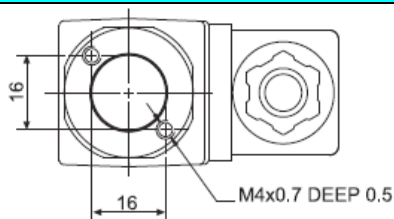

Model	A	B	C
PV6	6.5	5	10
PV8	9.5	6.5	10
PV9.5	9.5	6.5	10

Sizes in mm

