

Media: air – water – gas – fluid - vacuum
 Pressure range: 0 to 150 Bar max
 Media temperature: 180°C max
 Ambient temperature: -10°C to +50°C max
 Media viscosity: 50 centistokes max
 Mounting: any position
 Opening / Closing time: 20 mSec Max

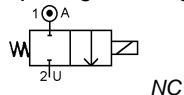

2/2 Stainless

1/4

NORMALLY CLOSED 2 WAY DIRECT ACTING

0 – 150 Bar

TYPE ADS8000



PRESSURE

Ø Port BSP	Ø Orifice (mm)	Coil	Flow Kv Ltr/min	Pressure Rating (bar) ΔP			Seals	Part Number
				Min	Max AC	Max DC		
1/4	1.2	WPG1	1.1	0	60	42	NBR +80°C SILICONE +120°C EPDM +120°C FKM +120°C *VST +180°C (30 Bar Max) *PTFE +180°C (150 Bar)	ADS8012 + seal + voltage
	1.6		1.5	0	40	28		ADS8016 + seal + voltage
	2.0		1.8	0	20	14		ADS8020 + seal + voltage
	1.2	WPG2	1.1	0	120	84		ADS8112 + seal + voltage
	1.6		1.6	0	60	42		ADS8116 + seal + voltage
	2.0		1.8	0	30	21		ADS8120 + seal + voltage
	3.0		4.3	0	20	14		ADS8130 + seal + voltage
	4.0	WPA3C	9.7	0	12	8.4		ADS8140 + seal + voltage
	5.0		10.7	0	10	7		ADS8150 + seal + voltage
	1.2		1.1	0	150	105		ADS8212 + seal + voltage
	1.6	1.5	0	80	56	ADS8216 + seal + voltage		
	2.0	1.8	0	60	42	ADS8220 + seal + voltage		
	3.0	4.3	0	40	28	ADS8230 + seal + voltage		
	4.0	9.7	0	20	14	ADS8240 + seal + voltage		
	5.0	10.7	0	15	10.5	ADS8250 + seal + voltage		

OPTIONS

IP67 (EN60529:1991+A1:2000) UL + CSA Approved Coil (Not WPA3C) & IP65 LED Connector PG11 – DIN 43650 A
 ATEX EExmII T4 II 2G & 2D IP65 T130°C Coil. ☹️ (Pressure rating WPG1 same, WPG2 70% of DC rating, WPA3C not available)
 * PTFE, VST, CR, ECO, HNBR or Hypalon Seals
 Silver shading ring (ADSxxxS)
 Manual Over Ride
 NPT Thread
 Other custom made options upon request

ELECTRICAL DATA

	Voltage (-10% + 15%) Continuous duty 100%	Coil	Power Consumption		Insulation class	Enclosure	Electrical connections
			Inrush	Holding			
~	24 - 110 - 230 (50 or 60 Hz)	WPG1	11.2VA	8.2VA	H 180°C	IP 65 with connector	3 spades DIN 43650A DIN 40050 VDE 0110
=	12 - 24 (DC)		12 Watts				
~	24 - 110 - 230 (50 or 60 Hz)	WPG2	18.7VA	15.3VA			
=	12 - 24 (DC)		18 Watts				
~	24 - 110 - 230 (50 or 60 Hz)	WPA3C	88VA	57VA			
=	12 - 24 (DC)		33.6 Watts				
						IP54	30 cm flying lead wires

CONSTRUCTION

Body: 316 Stainless steel
 Tube 304 stainless steel, armature 430F stainless steel
 Shading ring: copper (optional Silver)
 Seals and gaskets: FKM (Optional EPDM, NBR, SILICONE, PTFE, VST, CR, ECO, HNBR and Hypalon)
 Moulded coil: Resin

REPAIR KIT

Coil	Coil size (WPG1 or WPG2 or WPA3C) + voltage
Armature + Seal	SP210 + Valve Part Number

OVERALL DIMENSIONS

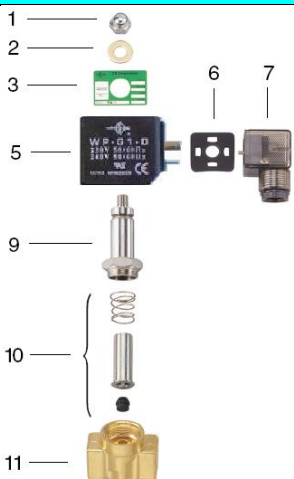

Item	Part No	Description
1	SP201-*	Nut
2	SP202-*	Washer
3	SP203-*	Nameplate
5	WP*	Coil
6	SP206-*	Gasket
7	SP207-*	Connector
9	SP209-*	Core Tube
10	SP210-*	Armature Assembly
17	SP211-*	Valve Body

* = Valve Part Number

Model	A	B	C	F	G	H	Kg
8012-8020	41	19	85	63	15	10.5	0.47
8112-8150	41	19	88	65	15	10.5	0.66
8212-8250	41	19	94	47	15	10.5	0.66

